

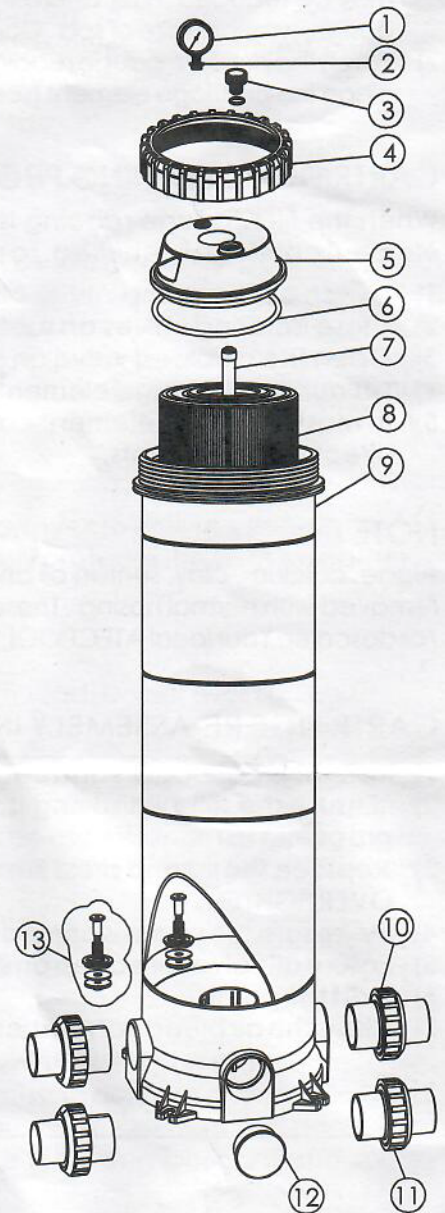

## REPLACEMENT PARTS

Key No.	Part No.	Description	Qty
1	06011032	Maximum 40PSI Indication, Stainless Steel Casing	1
2	89280120	Drain Plug Fitting	1
3	89010701	Air Release Valve with Oring	1
4	01021006	Ring Lock for Cartridge Filter	1
5	01011002	Cartridge Filter Lid	1
6	02011034	O-Ring for Lid	1
7	89060103	087510 PVC Air Vent Pipe With Cover	1
7	89060104	087511 PVC Air Vent Pipe With Cover	1
7	89060105	087512 PVC Air Vent Pipe With Cover	1
7	89060106	087513 PVC Air Vent Pipe With Cover	1
7	89060107	087514 PVC Air Vent Pipe With Cover	1
7	89060108	087515 PVC Air Vent Pipe With Cover	1
8	88270101	Element for 087510	1
8	88270102	Element for 087511	1
8	88270103	Element for 087512	1
8	88270104	Element for 087513	1
8	88270105	Element for 087514	1
8	88270106	Element for 087515	2
9	89060116	087510 Cartridge Filter Body	1
9	89060117	087511 Cartridge Filter Body	1
9	89060118	087512 Cartridge Filter Body	1
9	89060119	087513 Cartridge Filter Body	1
9	89060120	087514 Cartridge Filter Body	1
9	89060121	087515 Cartridge Filter Body	1
10	89060114	1.5" Union for Cartridge Filter	2
11	89060115	2.0" Union for Cartridge Filter	2
12	01011015	Plug	1
13	89060109	Pressure Release Valve	1



## WARNING

- ⚠ THIS FILTER OPERATES UNDER HIGH PRESSURE. WHEN ANY PART OF THE CIRCULATING SYSTEM (e.g., CLAMP, PUMP, FILTER, VALVES, ETC.) IS SERVICED, AIR CAN ENTER THE SYSTEM AND BECOME PRESSURIZED. PRESSURIZED AIR CAN CAUSE THE LID OR VALVE TO BE BLOWN OFF WHICH CAN RESULT IN SEVERE INJURY, DEATH, OR PROPERTY DAMAGE
- ⚠ TURN PUMP OFF BEFORE CHANGING VALVE POSITION.
- ⚠ TO PREVENT DAMAGE TO THE PUMP AND FOR PROPER OPERATION OF THE SYSTEM, CLEAN PUMP STRAINER AND SKIMMER BASKETS REGULARLY.
- ⚠ DO NOT UNSCREW SCREWS OF FLANGE CLAMP WHILE PUMP IS RUNNING.