

## Features

Side channel blower lubricated design for energy saving, broadband wide voltage design for convenience, centrifuge cycling design for stronger function, airflow buffer design for higher pressure and lower noise.

## Applications

Side channel blower widely applied in paper cutting machine, cigarette filter forming machine, plating bath liquor mixing, atomizing dryer, water treatment aeration, aquaculture, silk screen printing machine, photo engraving, injection molding machine, Automatic feeding machine, drying machinery, liquid filling machine, power filling machine, electric welding equipment, motion picture machine, Paper delivery, Dry cleaning cloths, Cleaning purposes, air cleaning, Gas's transmission feed and collect, Environment water treatment, environmental protection, food package, glasswork, pneumatic conveying, in a word, the applications is quite wide.

## Side channel blower Model Selection Methods

Owing to the wide applications, it is complicate to select the model. Generally speaking, there are two methods:

1. Make sure what the function you need, suction or blow. Then select the model through the related Pressure-airflow curve; if misread the curve, sometimes may lead to the products out of working.

2. Select the curve meets the demand of both pressure and airflow, and then select the type needed.

The need of the pressure and airflow is different according to the different working conditions. In order to get the exact data, there is need some calculation, which is suggested consulting the professional designer or companies.

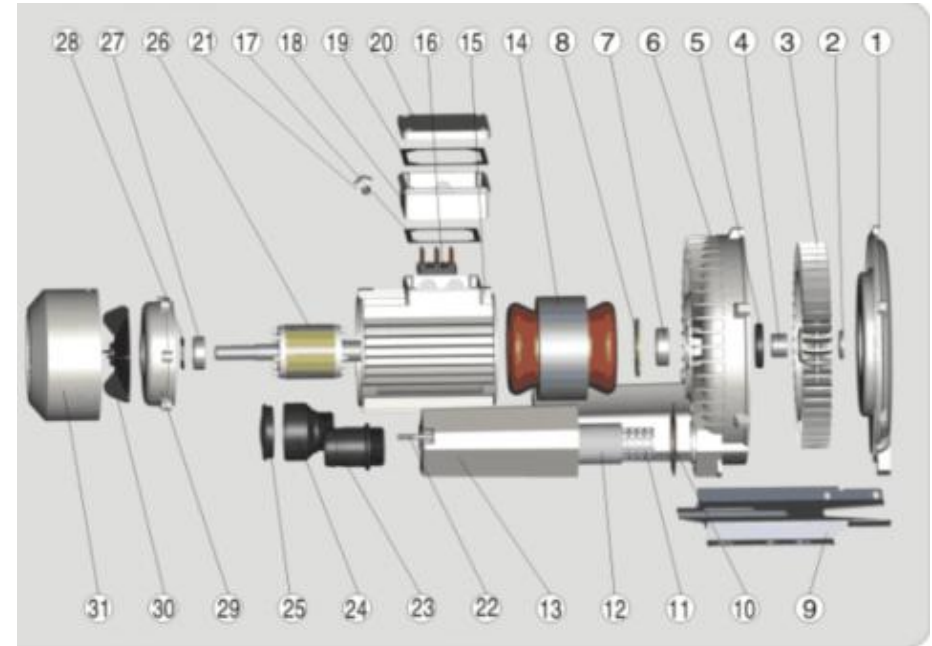

PARAMETER TABLE

MODEL	POWER	VOLTAGE FREQUENCY	AIR VOLUME	PRESSURE	DIMENSIONS
AH140-850	0.5KW	200V/240V 50HZ	80m³/h	130mbar	261X266X225
AH210-131	0.75KW	200V/240V 50HZ	145m³/h	160mbar	287x302x280
AH210-161	1.1KW	200V/240V 50HZ	185m³/h	160mbar	335x335x320
AH215-181	1.3KW	200V/240V 50HZ	210m³/h	170mbar	350x365x375
AH315-301	1.5KW	200V/240V 50HZ	255m³/h	220mbar	375x383x405
AH420-321	2.2KW	200V/240V 50HZ	318m³/h	230mbar	375x383x405
AH505-380	3KW	200V/240V 50HZ	376m³/h	410mbar	442x462x420
AH80-400	0.5KW	230V/50HZ	80m³/h	130mbar	261x266x225

Special protections are demanded in some special conditions. For instances, in case of sealed environment and in high temperature's inlet, more attentions to be paid to the ventilation cooling, or select the blower which allow inlet with high temperature (at present, the highest allowed temperature is 200 C Celsius).

Please contact with our local distributors for more detailed sample informations if needed. Thanks!

Agent/Distributor:
--------------------

### Technical Characteristics

1	Wind cover	13	Foot tube
2	Bearing cover	14	Stator
3	Wind leaf	15	Motor
4	Sleeve	16	Wiring board
5	Key	17~20	Terminal box & cover
6	Wind barrel	23~25	PF out/enter tooth hole
7	Seal cotton	26	Rotor
8	Oil seal	27	Bearing
9	Foot base	28	Wave spacer
10	Foot in charge of spacer	29	The back cover of the motor
11	Dis appear sound iron network	30	18PP heat dissipation leaf
12	Dis appear sound sponge	31	Heat dissipation iron cover

### Side channel blower Installation Notes

1. Necessary to use flat washer and spring cushion to the tighten the screw.

2. In case to have requirement to the noise, retrofitting the silencer installed in the end of inlet air channel or outlet channel for lower noise (generally about 5DB)

3. In case for high requirement to the noise, you can install disappear sound sponge. The manufacturer of blower or the professional noise treating company can supply more details.

4. When the sponge used, pay attention to some items: the distance between the blower and the box; ventilation and beat cooling. Dissipation of the blower, use Rubber buffer glue to bear the weight of the blower, especially the high power blower.

5. Necessary to use flexible pipe for insulate the shake in the connection between the inlet and outlet air channels.

6. Necessary to have two protections: pressure and powder, no matter what kind of the side channel blower.

To pressure, we generally adopt pressure relief valve, which is a unloading valve. When the pressure exceed the setting pressure from relief valve, in order to protect the blower, the relief valve will open automatically, releasing the extra pressure,

To powder, we generally adopt filter. Different filter has various accuracy in different applications, and has different maintain methods and service life. So make sure your need before ordering.

7. With comparison to centrifugal blower and medium pressure blower, side channel blower has higher pressure more than ten times, with output pressure top to 70KPA.